

Quarton RL24 Laser Diode Rod Lens Ø2x4.5mm

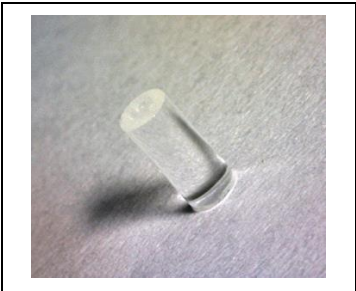

- FEATURES:**
- The Rod Lens is designed to transform collimated laser beam into a laser line.
 - The typical laser line emission angle is greater than 150°.

OUTLINE DIMENSIONS (UNITS: mm)

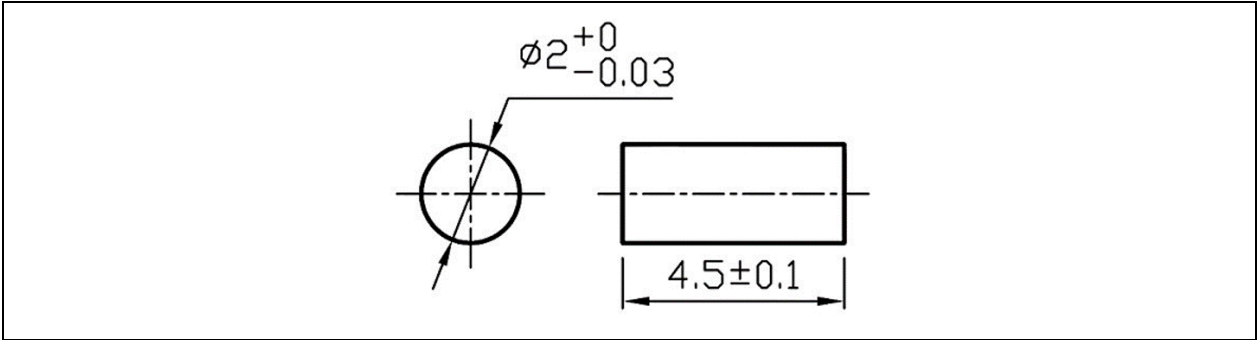

SPECIFICATIONS

Model Number:	RL24
Lens Material:	BK7
Lens Diameter:	Ø2.0 mm
Lens Length:	4.5 mm
Surface Quality:	40-20
Laser line emitting angle:	>150°
Storage Temperature:	-40 to 85°C
Operating Temperature:	-30 to 85°C